

# TITANIUM/HAP/PTFE Universal Trimmable

CODE  
TPL 07.59

Ti: Titanium ASTM F67 Gr. 2  
HAP: Porous Hydroxylapatite  
PTFE: Polytetrafluethylene

Universal prosthesis HAP/Ti/PTFE  
The prosthesis is composed by three elements: HAP and Ti structure, PTFE joint and Ti bell.

Features:

- HAP FLANGE – HAP flange can be placed directly in touch with tympanic membrane
- TYMPANUM FIXATION – Fixation of the prosthesis to the tympanum, led by the porosity, is possible thanks a double work: fisical link that fibroblasty creates entering the pores and chemical link thanks to hydroxilapatite bioactivity
- TITANIUM STRUCTURE – Titanium is a bioinert material, largely tested in surgery fields and with high mechanical resistance and lightness
- MOVING MALLEUS HOOK – this little hook can be used to clasp the malleus handle; if this work is not necessary, the little hook can be bent 90° downward to avoid decubitus on the tympanum
- PTFE JOINT – it is the joint between the prosthesis upper part and bell in the partial version or it is the ender part in the total version

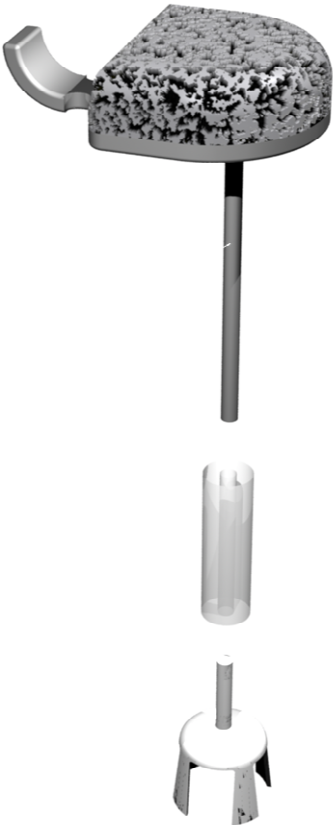

Total Version



Partial Version

TPL 07.59	
Total Version	Partial Version
L: from 7.50 to 3.00 mm Columella ø: 0.60 mm Weigth: from 23 mg (L=7.50 mm) to 22 mg (L=3.00 mm)	L: from 7.50 to 3.00 Ti Bell Inside ø: 1.10 mm Weigth: from 24 mg (L=7.50 mm) to 23 mg (L=3.00 mm)

Wire ø: 0.20 mm  
PTFE Joint ø: 0.60 mm



**Packaging**  
Dispenser box containing 6 sterile,  
individually packaged implants.

## 07.59 TITANIUM/HAP/PTFE Universal Trimmable - Total Version

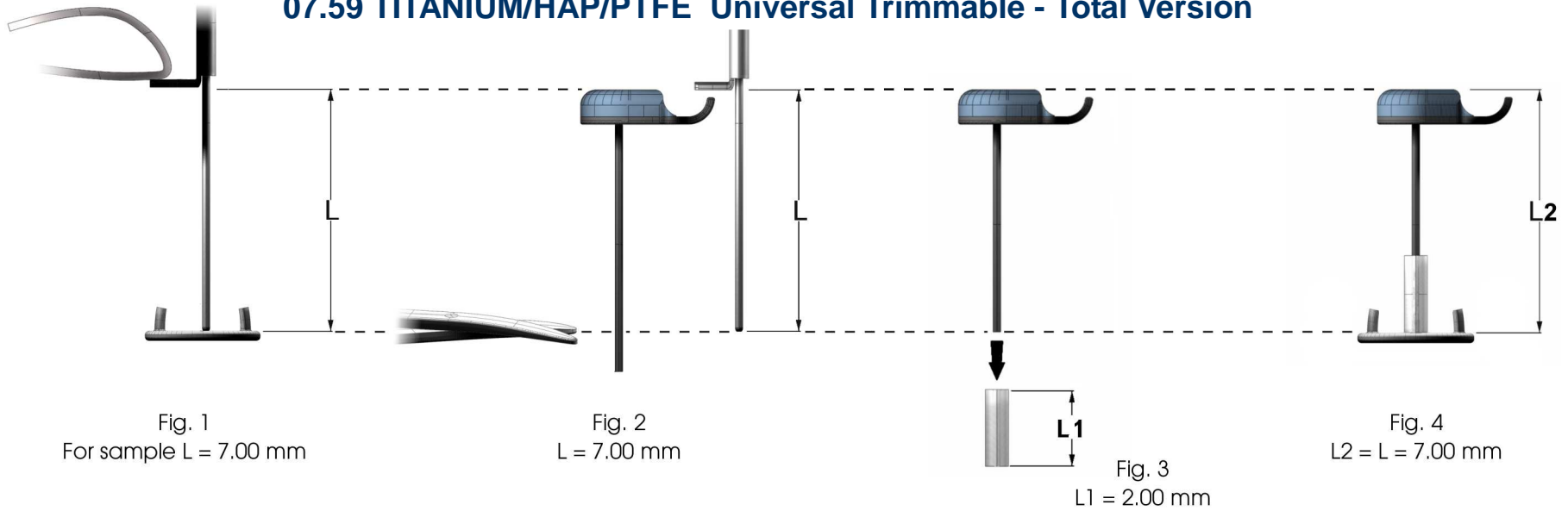

## 07.59 TITANIUM/HAP/PTFE Universal Trimmable - Partial Version

